

15-17 Eastgate Street, Bury St Edmunds, Suffolk, IP33 1XX
Tel: 01284 760770
bury@shiresestateagents.co.uk
www.shiresresidential.com

shires

Estate & Letting Agents



Brackenwood Crescent, Bury St. Edmunds, Suffolk, IP32 7JN

Shires are pleased to offer to let this modern semi-detached house located on the popular Bartons development close to amenities and within easy reach of the town centre. The property comprises Entrance Hall, Kitchen, Sitting/Dining Room, Conservatory, Two Bedrooms and Bathroom. To the rear there is an enclosed garden and allocated parking. Available end of August 2025.

- MODERN SEMI-DETACHED HOUSE
- SITTING/DINING ROOM, CONSERVATORY
- BATHROOM
- ELECTRIC HEATING, UNFURNISHED, EPC 69, C
- AVAILABLE END OF AUGUST 2025
- ENTRANCE HALL, KITCHEN
- TWO BEDROOMS
- GARDEN AND ALLOCATED PARKING
- MINIMUM TERM TENANCY OF TWELVE MONTHS



Council Tax Band: B - EPC Rating: D 68

GROUND FLOOR

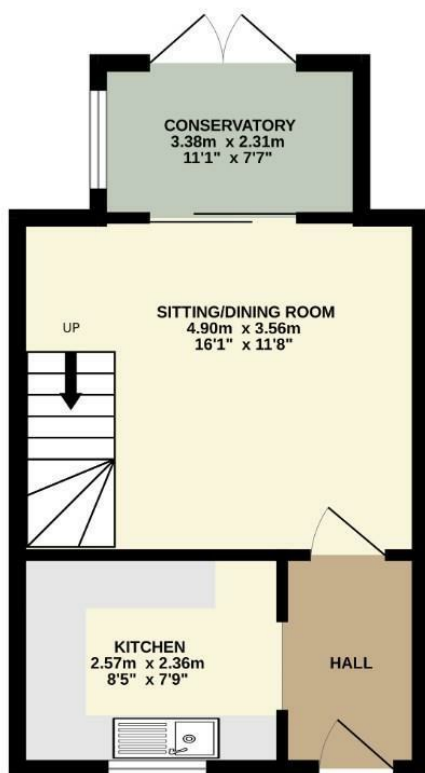

1ST FLOOR

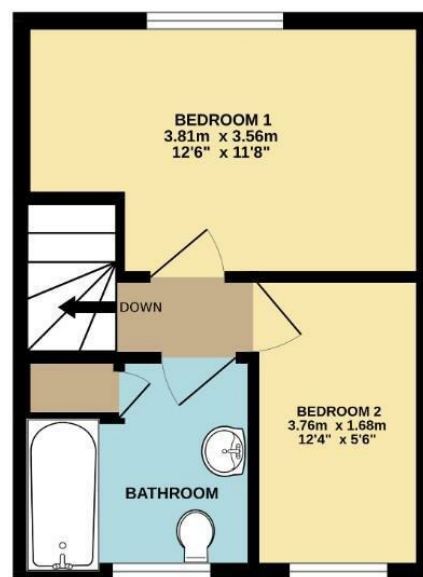

Whilst every attempt has been made to ensure the accuracy of the floorplan contained here, measurements of doors, windows, rooms and any other items are approximate and no responsibility is taken for any error, omission or mis-statement. This plan is for illustrative purposes only and should be used as such by any prospective purchaser. The services, systems and appliances shown have not been tested and no guarantee as to their operability or efficiency can be given.
Made with Metropix 6/2025

